

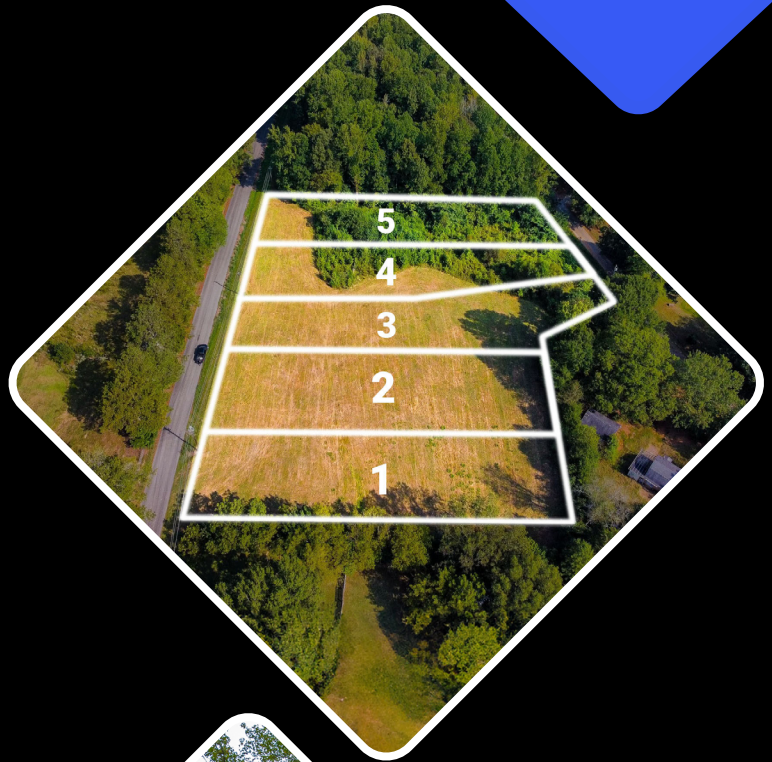

Alcorn County Mississippi's Premier Jewel

Explore possibilities in Alcorn County, MS, with one of these land plots. Design your dream home in a tranquil setting that combines countryside charm with local convenience. Welcome to Premier Jewel of the south, where your vision meets Mississippi's natural beauty.



(970) 829-8580



howdy@debrosland.com



www.debrosland.com

ACREAGE SIZES:

0.3 - 0.6

STATE:
MISSISSIPPI

COUNTY:
ALCORN

NEAREST CITY:
CORINTH



County:
Pontotoc, MS



Trash:
Yes



Elevation:
480' - 490'



Zoning:
N/A

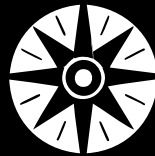

Coordinates:
34.936360°
-88.469840°

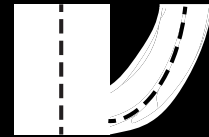

Access:
Paved



Power:
Yes



Water:
Requires Well

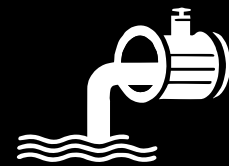

Sewage:
Requires Septic

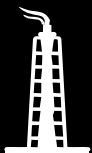

Gas:
Yes



Phone & Internet:
Yes



(970) 829-8580



howdy@debrosland.com



www.debrosland.com

Alcorn County Mississippi's Premier Jewel

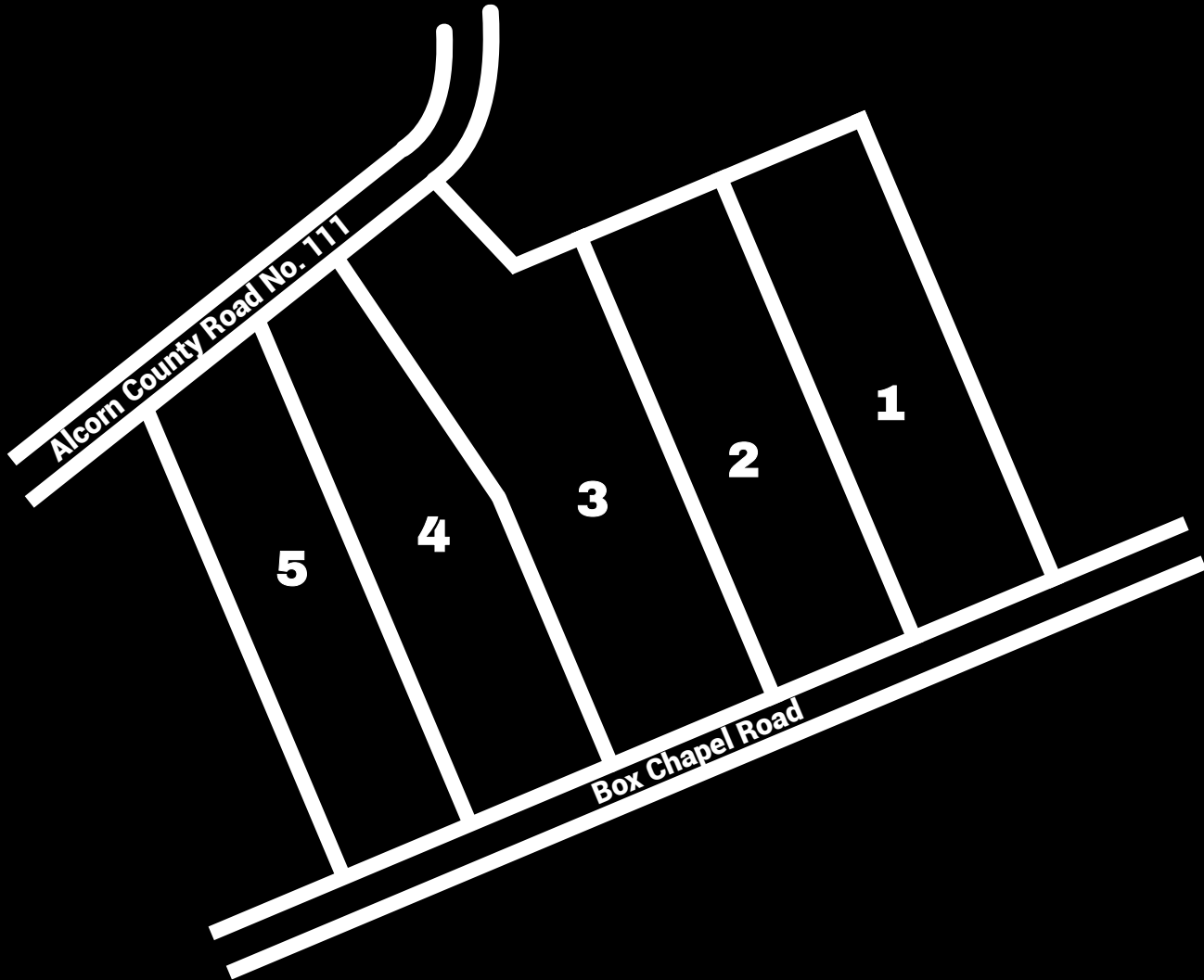

Lot ID	Size
Alcorn_01_MS	0.59
Alcorn_02_MS	0.60
Alcorn_03_MS	0.76
Alcorn_04_MS	0.65
Alcorn_05_MS	0.61



(970) 829-8580



howdy@debrosland.com



www.debrosland.com



Utility Information:

Power Information:

ACE POWER
<https://ace-power.com/>
(662) 287-4402

Gas Information:

Corinth Gas & Water
(662) 286-2263

Trash Information:

City of Corinth
662-489-2415

Water Information:

Farmington Water Association
(662) 286-2815

Phone & Internet Information:

AT&T: <https://www.att.com/>
800.288.2020
Frontier: <https://internet.frontier.com/>
1-855-885-5528

County Information:

Assessor's Office:

<https://www.alcorncounty.org/tax-assessor/>
(662) 286-7733

Clerk and Recorder's Office:

<https://www.alcorncounty.org/chancery-clerk/>
(662) 286-7700

Treasurer's Office:

<https://www.alcorncounty.org/tax-collector/>
(662) 286-7750

Disclosure Statement:

Debrosland, its managers, employees and all other affiliates do lengthy research on all properties prior to listing them, in all cases we have not seen the property. All prospective buyers are encouraged to conduct their own due diligence to verify the information provided is accurate and contact the county to confirm that whatever plans you as the buyer have for the property in question are in fact legal, feasible and permitted to your satisfaction. We make no warranties or representations about the land, its condition, or what can be done with the property. Due diligence is encouraged but is the buyer's responsibility and all sales are final. If you visit any of our properties, you are visiting at your own risk and release our company and all its managers, employees and other affiliates from any and all claims or liabilities. To see a full list of our disclosure statement and other notices please visit our [Terms & Conditions](#).