

CHATHAM COUNTY ENVIRONMENTAL HEALTH

P. O. Box 130 / 80 East St.
 Pittsboro, N.C. 27312-0130
 542-8208

1000 S. 10th Avenue
 Siler City, N. C. 27344
 742-4911

WELL PERMIT

- New Well
 Replacement Well

THIS PERMIT EXPIRES FIVE YEARS FROM DATE OF ISSUE.

OWNER Thomas W. MOSES ADDRESS 389 Dewitt Smith Rd

Directions to Site Pittsboro - Goldston Rd (R) Dewitt Smith Rd
property on left

WELL TO SERVE: Residence Mobile Home Park Other

Sketch of Well Site

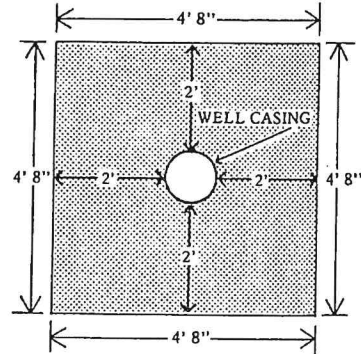
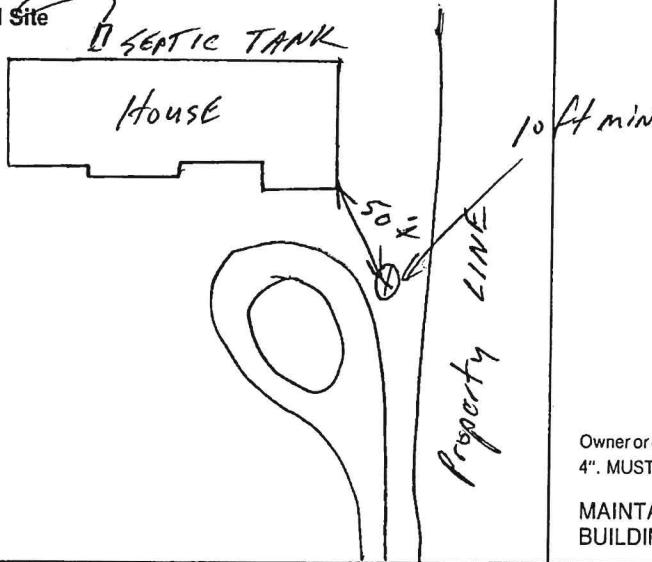

CONCRETE WELL SLAB (top view)

Owner or contractor required to pour concrete slab around well casing, 4'8" x 4'8" x 4". MUST BE COMPLETED BEFORE APPROVAL OF PRIVATE WATER SUPPLY.

MAINTAIN 100' FROM ALL SEPTIC AREAS, 50' FROM ANY BUILDING FOUNDATION & 10' FROM ANY PROPERTY LINE.

WELL CONSTRUCTION

Distance from nearest property line 30'±
 Distance from source of pollution 100'
 Total depth of well 303 ft. GPM 4
 Water Bearing Zones: Depth 1e 35 Ft. 1e 220 Ft. 2e 265 Ft. Ft. Ft.
 Casing Depth: From 0 to 42 Ft. Diameter 64
 Static Water Level 30
 Casing Type: Steel Galvanized Steel Thickness .188

If steel, does owner approve: Yes No

Drive Shoe Yes No Height of casing above ground 12 inches

Problems in setting casing Yes No Explain _____

Grout Type: Neat Sand/Cement Concrete Annular space width 3 In.
 Water in Annular space Yes No Method of Grout: Pump Pressure Poured
 No. Bags of Portland Cement 5 total Depth From 0 to 80 Ft.
 Weight of 1 bag 94 lbs. Proper Slab Constructed ID Plate Chlorination Yes No

DEPTH		DRILLING LOG
From	To	FORMATION DESCRIPTION
0	20	Dirt
20	303	Granite

I hereby certify that the above information is correct and that this well was constructed in accordance with the Chatham County Well Ordinance.

Don Pike 12-22-06
 Signature of Contractor Date

Permit Issued By James Carl Knott, R.S. Date 12-12-06

Well Grout Inspected by Jim Wagner, R.S. Date 12/22/06

Inspection Completed by Mary Blum, RS Date March 27, 2007

NAME/SUBDIVISION Moses, Thomas W. 911 Address 389 Dewitt Smith Rd

Moses, Thomas

Lot
Block
Map

The District Health Department

CASWELL - CHATHAM - LEE - PERSON COUNTIES

Water Supply and Sewage Disposal

IMPROVEMENTS PERMIT No. _____

Date 5-24-79

Owner: Thomas Moses

Location: 1st house on left
S.R. 2076

Contractor: Ralph Foysee

Water Supply: Private Public

Sewage Disposal Facilities: No. bedrooms _____ Dishwasher, Disposal, washing machine, other automatic appliances _____

Size of tank: _____ Nitrification line: 360X3

Other disposal facility: _____

Water supply and sewage disposal facilities location, installation and protection must meet state and local regulations.

Septic tank should be pumped out every 3 to 5 years and shall be maintained by owner in such a manner as not to create a public health hazard. Septic tank and nitrification line **MUST BE INSPECTED AND APPROVED BY A MEMBER OF THE DISTRICT HEALTH DEPARTMENT STAFF BEFORE ANY PORTION OF THE INSTALLATION IS COVERED AND PUT INTO USE.**

Date approved: _____

Well: _____

Sewage Disposal: _____

By: _____

Signed [Signature]
Sanitarian

Counter-signed _____
(Owner or his representative)

Certificate of Completion

Date Approved: 5-24-79 By: [Signature]
Sanitarian

(OVER)

Location of well and sewage disposal facilities sketched on back.

NOTE: Make sketch of installation showing lot size and shape, location of house, septic tanks, privies, water supplies, etc. Note special problems existing on lot. Write in measurements in order that installations may be located at later date. Note location of water supplies on adjacent lots.

(1)

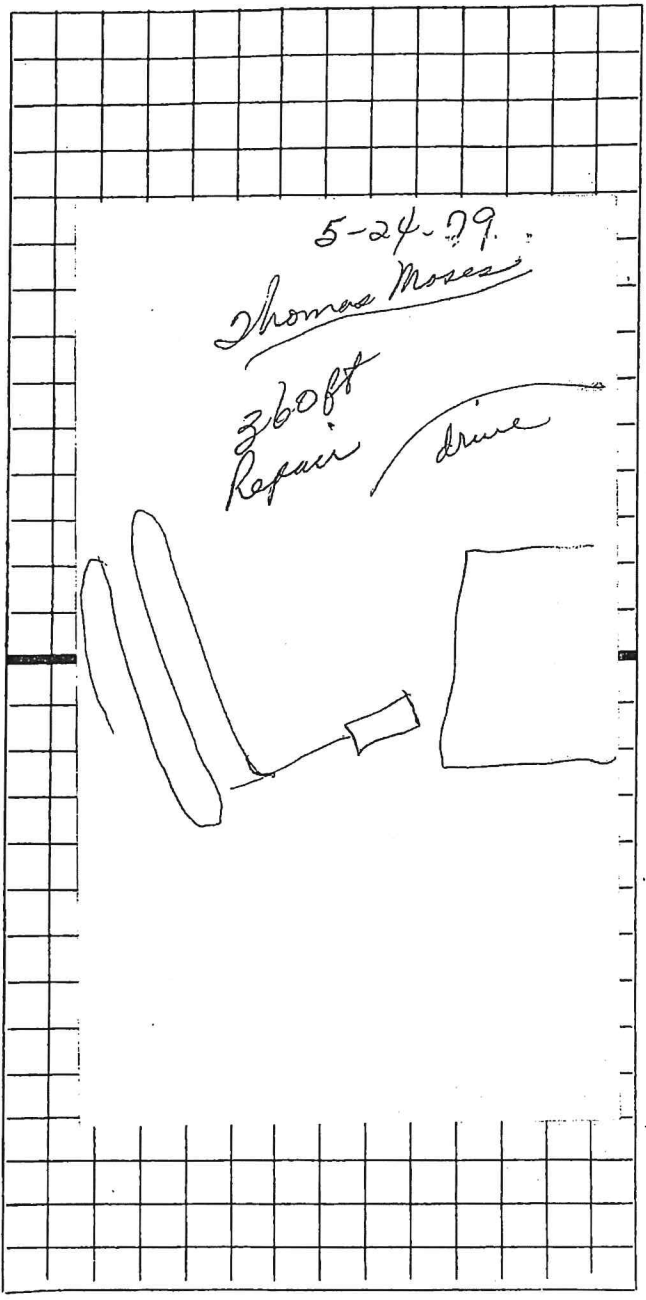

(2)





Private Well & Wastewater Disposal Setback Compliance Approval
CHATHAM COUNTY PUBLIC HEALTH DEPARTMENT
DIVISION OF ENVIRONMENTAL HEALTH
80 EAST ST, P.O. BOX 130 • PITTSBORO, NC 27312-0130
PHONE 919-542-8208 • FAX 919-542-8288
www.chathamnc.org/environmentalhealth

Approval Valid for 6 Months From Date of Issuance

Owner: Robert A. Watkins

Mailing Address: 389 Dewitt Smith Rd. Pittsboro, NC 27312

Physical Address of Property: Same

Parcel Number: 12434 Water Supply: Private Public Community

Wastewater System Type: II Conventional

Number of Bedrooms: 3 or Business Type: _____ Number of Occupants: 6 max

*Approval is for: Proposed 35' x 60' Detached Garage with Half Bath and a 25' x 40' Barn

Sketched Site Plan:

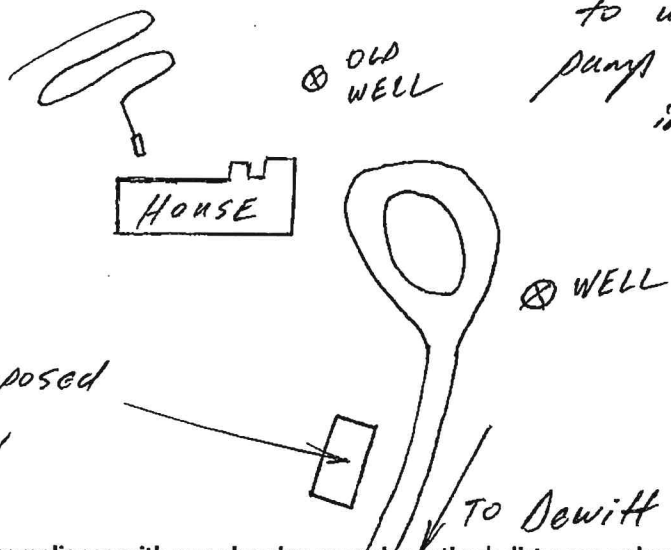

* OWNER intends to use grinder pump for Half Bath in Garage

*The approval does not constitute compliance with any planning or zoning setback distances or land use requirements of the planning jurisdiction in which the property is located.

The Environmental Health Division recommends the property owners have their wells sampled for bacteria once a year. It is recommended to clean the septic tank effluent filter every year and pump the tank routinely (every 3-5 years with average use) to ensure proper operation and prolong the life of the system.

Approved by: James Carl Knieth, REHS Date: 4-18-16
Registered Environmental Health Specialist

389 Dewitt Smith Rd. Pittsboro, NC 27312
911 Address

12434
Parcel Number

Watkins, Robert A.
Name/Subdivision Name