

LINE	BEARING	DISTANCE
L1	N 58°08'44" E	307.52'
L2	S 58°08'44" W	307.52'

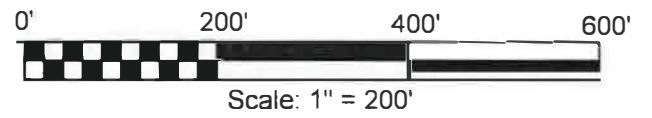

**J. KORTICKY SURVEY  
ABSTRACT No. 513**

JACKSON L. GUTIERREZ AND  
LADONNA K. GUTIERREZ  
CALLED 143.192 ACRES  
VOL. 2073, PG. 667  
O.P.R.H.C.T.

**SYMBOL LEGEND**

- +—+— PIPELINE
- x—x— WIRE FENCE
- v—v— TOP OF BANK
- - - FLOW LINE
- ▲—▲— EDGE OF WATER
- SET SURVEY MONUMENT
- FND SURVEY MONUMENT
- ⊕ FIBER OPTIC MARKER (FM)
- ⊞ TELEPHONE PEDESTAL (TP)
- ⊠ PIPELINE MARKER



**EPHRAIM GOSS SURVEY  
ABSTRACT No. 346**

REMAINDER OF  
MARK L. MORRIS AND  
L. RACHELLE MORRIS  
CALLED 121.240 ACRES  
VOL. 1226, PG. 188  
O.P.R.H.C.T.

CHARLES C. HAMILTON AND  
MARY B. HAMILTON  
CALLED 103.93 ACRES  
VOL. 1914, PG. 118  
O.P.R.H.C.T.

**TRACT 1  
12.021 ACRES**

PORTION OF  
MARK L. MORRIS AND  
L. RACHELLE MORRIS  
CALLED 121.240 ACRES  
VOL. 1226, PG. 188  
O.P.R.H.C.T.

THE SUBJECT TRACT(S) AS SHOWN HEREON MAY BE SUBJECT TO THE FOLLOWING ITEMS:

1. R.O.W. TO HILL COUNTY ELECTRIC COOPERATIVE, INC PER VOL. 294, PG. 415, D.R.H.C.T.
2. EASEMENT TO TEXAS POWER AND LIGHT PER VOL. 336, PG. 432, D.R.H.C.T.
3. EASEMENT TO TEXAS PIPELINE COMPANY PER VOL. 336, PG. 537, D.R.H.C.T.
4. EASEMENT TO CHATT WATER SUPPLY PER VOL. 483, PG. 262, D.R.H.C.T.

**BOUNDARY SURVEY**

BEING A 12.021 ACRE TRACT SITUATED IN THE EPHRAIM GOSS SURVEY, ABSTRACT NUMBER 346, HILL COUNTY, TEXAS, BEING A PORTION OF THAT CERTAIN CALLED 121.240 ACRE TRACT DESCRIBED IN INSTRUMENT TO MARK L. MORRIS AND L. RACHELLE MORRIS, RECORDED IN VOLUME 1226, PAGE 188 OF THE OFFICIAL PUBLIC RECORDS OF HILL COUNTY, TEXAS (O.P.R.H.C.T.), SAID 12.021 ACRE TRACT BEING MORE PARTICULARLY DESCRIBED BY ATTACHED METES AND BOUNDS DESCRIPTION

**GENERAL NOTES:**

- 1) THIS SURVEY WAS PERFORMED WITHOUT BENEFIT OF A CURRENT TITLE REPORT. SURVEYOR DID NOT ABSTRACT TITLE AND DOES NOT CERTIFY TO EASEMENTS OR RESTRICTIONS NOT SHOWN. CHECK WITH YOUR LOCAL GOVERNING AGENCIES FOR ANY ADDITIONAL EASEMENTS, BUILDING LINES OR OTHER RESTRICTIONS NOT REFLECTED ON SURVEY.

PROJECT NUMBER	23595_TR1
DATE	03-04-2022
DRAWN BY	AF
CHECKED BY	-
FIELD CREW	JW
REVISION 1	-
REVISION 2	-
REVISION 3	-
REVISION 4	-

NO PORTION OF THIS PROPERTY APPEARS TO LIE WITHIN THE 100 YEAR FLOODPLAIN PER GRAPHIC SCALING OF COMMUNITY PANEL NO. 48217C0425D HAVING AN EFFECTIVE DATE OF 12/20/2019.

BASIS OF BEARINGS: BEARINGS AND DISTANCES SHOWN HEREON ARE BASED ON GPS OBSERVATIONS AND ARE REFERENCED TO THE NORTH AMERICAN DATUM OF 1983 (NAD83), TEXAS STATE PLANE COORDINATE SYSTEM, CENTRAL ZONE (TXC-4203), GRID MEASUREMENTS.

PURCHASER.....DRISCOLL HOLDINGS, LLC AND/OR ASSIGNS  
ADDRESS.....COUNTY RD 3137, HILLSBORO, TX, 76645  
SURVEY.....EPHRAIM GOSS, A - 346  
AREA.....12.021 ACRES  
COUNTY.....HILL

I HEREBY CERTIFY THAT THIS SURVEY WAS THIS DAY MADE UNDER MY SUPERVISION ON THE GROUND OF THE ABOVE DESCRIBED PROPERTY, AND THAT THE ABOVE PLAT OR DRAWING REFLECTS THE FINDINGS ON THE GROUND OF THE PROPERTY AT THIS TIME AND THAT THIS SURVEY MEETS THE MINIMUM STANDARDS OF PRACTICE AS APPROVED BY THE TEXAS BOARD OF PROFESSIONAL LAND SURVEYING.

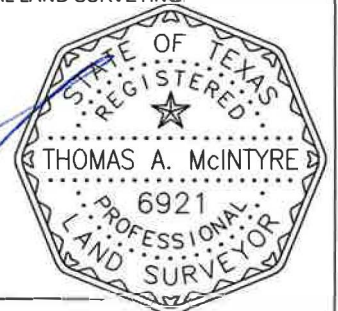

Thomas A. McIntyre  
Registered Professional Land Surveyor No. 6921

**TEXAS**  
PROFESSIONAL  
SURVEYING, LLC  
3032 N. FRAZIER STREET - CONROE, TX  
77303 P11 (936)756-7447 - FAX (936)756-7448  
WWW.SURVEYINGTEXAS.COM  
FIRM REGISTRATION NO. 100834-00