

**UNIT K-1, SUBDIVISION
OF
FORBES PARK**

SITUATED IN A PORTION OF THE
SANGRE DE CRISTO GRANT IN T.30 S., R.68 & 70 W. 6th P.M.,
COSTILLA COUNTY, COLORADO

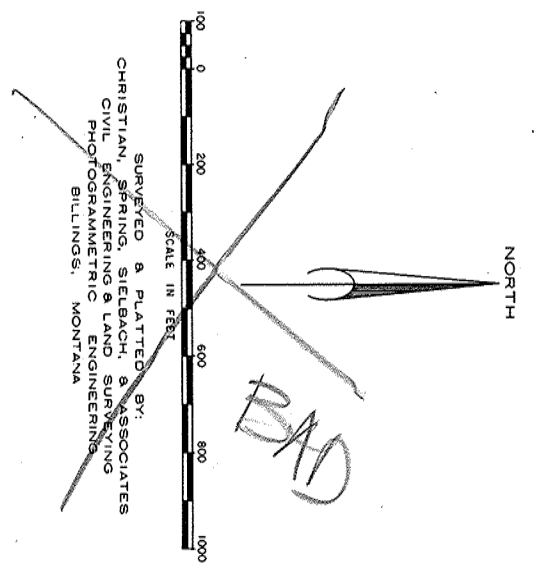

- NOTES:
1. ALL BUILDING LOT AREA, WAS DETERMINED
 2. ALL DIMENSIONS SHOWN ARE IN FEET
 3. REBAR WITH PLASTIC CAPS
 4. 6" WIDE REINFORCED CONCRETE STREET ROAD
 5. WHICH IS TO BE WIDE 10'
 6. GROUND PLATTED AREA, 256,228
 7. 6.57 ACRES
 8. 288,000 SQ. FT.
 9. 2.65 ACRES
 10. 288,000 SQ. FT.
 11. 2.65 ACRES
 12. 288,000 SQ. FT.
 13. 2.65 ACRES
 14. 288,000 SQ. FT.
 15. 2.65 ACRES
 16. 288,000 SQ. FT.
 17. 2.65 ACRES
 18. 288,000 SQ. FT.
 19. 2.65 ACRES
 20. 288,000 SQ. FT.
 21. 2.65 ACRES
 22. 288,000 SQ. FT.
 23. 2.65 ACRES
 24. 288,000 SQ. FT.
 25. 2.65 ACRES
 26. 288,000 SQ. FT.
 27. 2.65 ACRES
 28. 288,000 SQ. FT.
 29. 2.65 ACRES
 30. 288,000 SQ. FT.
 31. 2.65 ACRES
 32. 288,000 SQ. FT.
 33. 2.65 ACRES
 34. 288,000 SQ. FT.
 35. 2.65 ACRES
 36. 288,000 SQ. FT.
 37. 2.65 ACRES
 38. 288,000 SQ. FT.
 39. 2.65 ACRES
 40. 288,000 SQ. FT.
 41. 2.65 ACRES
 42. 288,000 SQ. FT.
 43. 2.65 ACRES
 44. 288,000 SQ. FT.
 45. 2.65 ACRES
 46. 288,000 SQ. FT.
 47. 2.65 ACRES
 48. 288,000 SQ. FT.
 49. 2.65 ACRES
 50. 288,000 SQ. FT.
 51. 2.65 ACRES
 52. 288,000 SQ. FT.
 53. 2.65 ACRES
 54. 288,000 SQ. FT.
 55. 2.65 ACRES
 56. 288,000 SQ. FT.
 57. 2.65 ACRES
 58. 288,000 SQ. FT.
 59. 2.65 ACRES
 60. 288,000 SQ. FT.
 61. 2.65 ACRES
 62. 288,000 SQ. FT.
 63. 2.65 ACRES
 64. 288,000 SQ. FT.
 65. 2.65 ACRES
 66. 288,000 SQ. FT.
 67. 2.65 ACRES
 68. 288,000 SQ. FT.
 69. 2.65 ACRES
 70. 288,000 SQ. FT.
 71. 2.65 ACRES
 72. 288,000 SQ. FT.
 73. 2.65 ACRES
 74. 288,000 SQ. FT.
 75. 2.65 ACRES
 76. 288,000 SQ. FT.
 77. 2.65 ACRES
 78. 288,000 SQ. FT.
 79. 2.65 ACRES
 80. 288,000 SQ. FT.
 81. 2.65 ACRES
 82. 288,000 SQ. FT.
 83. 2.65 ACRES
 84. 288,000 SQ. FT.
 85. 2.65 ACRES
 86. 288,000 SQ. FT.
 87. 2.65 ACRES
 88. 288,000 SQ. FT.
 89. 2.65 ACRES
 90. 288,000 SQ. FT.
 91. 2.65 ACRES
 92. 288,000 SQ. FT.
 93. 2.65 ACRES
 94. 288,000 SQ. FT.
 95. 2.65 ACRES
 96. 288,000 SQ. FT.
 97. 2.65 ACRES
 98. 288,000 SQ. FT.
 99. 2.65 ACRES
 100. 288,000 SQ. FT.



COMMON PREFERRED
(RECREATION ONLY)

COMMON PREFERRED
(RECREATION ONLY)

CERTIFICATE OF DEDICATION

I, **Paul S. Campbell**, of the County of Costilla, State of Colorado, do hereby certify that the above described streets, roads, and ways, have been dedicated to the public use of the County of Costilla, State of Colorado, and that the same have been accepted by the Board of Commissioners of the County of Costilla, State of Colorado, and that the same are now a part of the public domain of the County of Costilla, State of Colorado.

Witness my hand and the seal of the County of Costilla, State of Colorado, this 15th day of August, 1970.

Paul S. Campbell
County Clerk

DECLARATION OF PREPARATION

I, **Paul S. Campbell**, of the County of Costilla, State of Colorado, do hereby declare that the above described streets, roads, and ways, have been dedicated to the public use of the County of Costilla, State of Colorado, and that the same have been accepted by the Board of Commissioners of the County of Costilla, State of Colorado, and that the same are now a part of the public domain of the County of Costilla, State of Colorado.

Witness my hand and the seal of the County of Costilla, State of Colorado, this 15th day of August, 1970.

Paul S. Campbell
County Clerk

STATE OF COLORADO

County of Costilla

Subdivision of Unit K-1, Forbes Park

Recorded in Book 126, Page 178

Paul S. Campbell
County Clerk

UNIT K-1, SUBDIVISION OF FORBES PARK

Block 178, Block 175, Block 174, Block 173, Block 172, Block 171, Block 170, Block 169, Block 168, Block 167, Block 166, Block 165, Block 164, Block 163, Block 162, Block 161, Block 160, Block 159, Block 158, Block 157, Block 156, Block 155, Block 154, Block 153, Block 152, Block 151, Block 150, Block 149, Block 148, Block 147, Block 146, Block 145, Block 144, Block 143, Block 142, Block 141, Block 140, Block 139, Block 138, Block 137, Block 136, Block 135, Block 134, Block 133, Block 132, Block 131, Block 130, Block 129, Block 128, Block 127, Block 126, Block 125, Block 124, Block 123, Block 122, Block 121, Block 120, Block 119, Block 118, Block 117, Block 116, Block 115, Block 114, Block 113, Block 112, Block 111, Block 110, Block 109, Block 108, Block 107, Block 106, Block 105, Block 104, Block 103, Block 102, Block 101, Block 100, Block 99, Block 98, Block 97, Block 96, Block 95, Block 94, Block 93, Block 92, Block 91, Block 90, Block 89, Block 88, Block 87, Block 86, Block 85, Block 84, Block 83, Block 82, Block 81, Block 80, Block 79, Block 78, Block 77, Block 76, Block 75, Block 74, Block 73, Block 72, Block 71, Block 70, Block 69, Block 68, Block 67, Block 66, Block 65, Block 64, Block 63, Block 62, Block 61, Block 60, Block 59, Block 58, Block 57, Block 56, Block 55, Block 54, Block 53, Block 52, Block 51, Block 50, Block 49, Block 48, Block 47, Block 46, Block 45, Block 44, Block 43, Block 42, Block 41, Block 40, Block 39, Block 38, Block 37, Block 36, Block 35, Block 34, Block 33, Block 32, Block 31, Block 30, Block 29, Block 28, Block 27, Block 26, Block 25, Block 24, Block 23, Block 22, Block 21, Block 20, Block 19, Block 18, Block 17, Block 16, Block 15, Block 14, Block 13, Block 12, Block 11, Block 10, Block 9, Block 8, Block 7, Block 6, Block 5, Block 4, Block 3, Block 2, Block 1.

Lot No.	Area (Acres)	Perimeter (Feet)
1	0.01	100
2	0.01	100
3	0.01	100
4	0.01	100
5	0.01	100
6	0.01	100
7	0.01	100
8	0.01	100
9	0.01	100
10	0.01	100
11	0.01	100
12	0.01	100
13	0.01	100
14	0.01	100
15	0.01	100
16	0.01	100
17	0.01	100
18	0.01	100
19	0.01	100
20	0.01	100
21	0.01	100
22	0.01	100
23	0.01	100
24	0.01	100
25	0.01	100
26	0.01	100
27	0.01	100
28	0.01	100
29	0.01	100
30	0.01	100
31	0.01	100
32	0.01	100
33	0.01	100
34	0.01	100
35	0.01	100
36	0.01	100
37	0.01	100
38	0.01	100
39	0.01	100
40	0.01	100
41	0.01	100
42	0.01	100
43	0.01	100
44	0.01	100
45	0.01	100
46	0.01	100
47	0.01	100
48	0.01	100
49	0.01	100
50	0.01	100
51	0.01	100
52	0.01	100
53	0.01	100
54	0.01	100
55	0.01	100
56	0.01	100
57	0.01	100
58	0.01	100
59	0.01	100
60	0.01	100
61	0.01	100
62	0.01	100
63	0.01	100
64	0.01	100
65	0.01	100
66	0.01	100
67	0.01	100
68	0.01	100
69	0.01	100
70	0.01	100
71	0.01	100
72	0.01	100
73	0.01	100
74	0.01	100
75	0.01	100
76	0.01	100
77	0.01	100
78	0.01	100
79	0.01	100
80	0.01	100
81	0.01	100
82	0.01	100
83	0.01	100
84	0.01	100
85	0.01	100
86	0.01	100
87	0.01	100
88	0.01	100
89	0.01	100
90	0.01	100
91	0.01	100
92	0.01	100
93	0.01	100
94	0.01	100
95	0.01	100
96	0.01	100
97	0.01	100
98	0.01	100
99	0.01	100
100	0.01	100