

# Christian County, KY PVA

## Summary

**Parcel Number** 115-00-00-020.00  
**Account Number** 62797  
**Location Address** 11750 MADISONVILLE RD S  
**Description** 11750 S MADISONVILLE RD  
(Note: Not to be used on legal documents)  
**Class** FARM (20)  
**Tax District** 00-County  
**Deed Book/Page** 697-695

[View Map](#)



## Tax Rates

[See Tax Rates](#)

## Owner

BARNETT JOHN L  
 3785 CROFTON DAWSON RD  
 CROFTON, KY 42217

## Valuation

Assessed Year	2025	2024
	Working Tax Roll	Certified Tax Roll
Total Assessed Value		
Farm Fair Cash Value	\$258,150.00	\$258,150.00
Farm Taxable Value	\$158,539.00	\$158,539.00

## Sales Information

Sale Date	Sale Price	Deed Book	Deed Page	Grantee	Grantor
8/29/2013	\$0	697	695	BARNETT JOHN L	BARNETT GEORGE W

## Land Information

Condition	None	Topography	Not Used
Plat Book/Page		Drainage	None
Subdivision		Flood Hazard	
Lot		Zoning	Residential
Block		Electric	No
Acres	42.55	Water	No
Front	0	Gas	No
Depth	0	Sewer	No
Lot Size	0x0	Road	2 Lane
Lot Sq Ft	1853478	Sidewalks	No
Shape	None	Information Source	

## Improvement Information

Description	HOUSE	Heat	Bottled Gas
Type	Single Family	AC	
Year Built	0	Living Sqft	2062
Foundation	Concrete Block	Basement Sqft	0
Basement	BT-None, None	Garage Sqft	345
Exterior	Cut Stone	Porch Sqft	0
Bedrooms	0	Patio Sqft	0
Full Baths	0	Basement Finish	BT-None, None
Half Baths	0	Structure	
Roof Cover	RF-Metal	Garage	Attached Garage
Condition	None		
Fireplace	True		

## Photos



Sketches

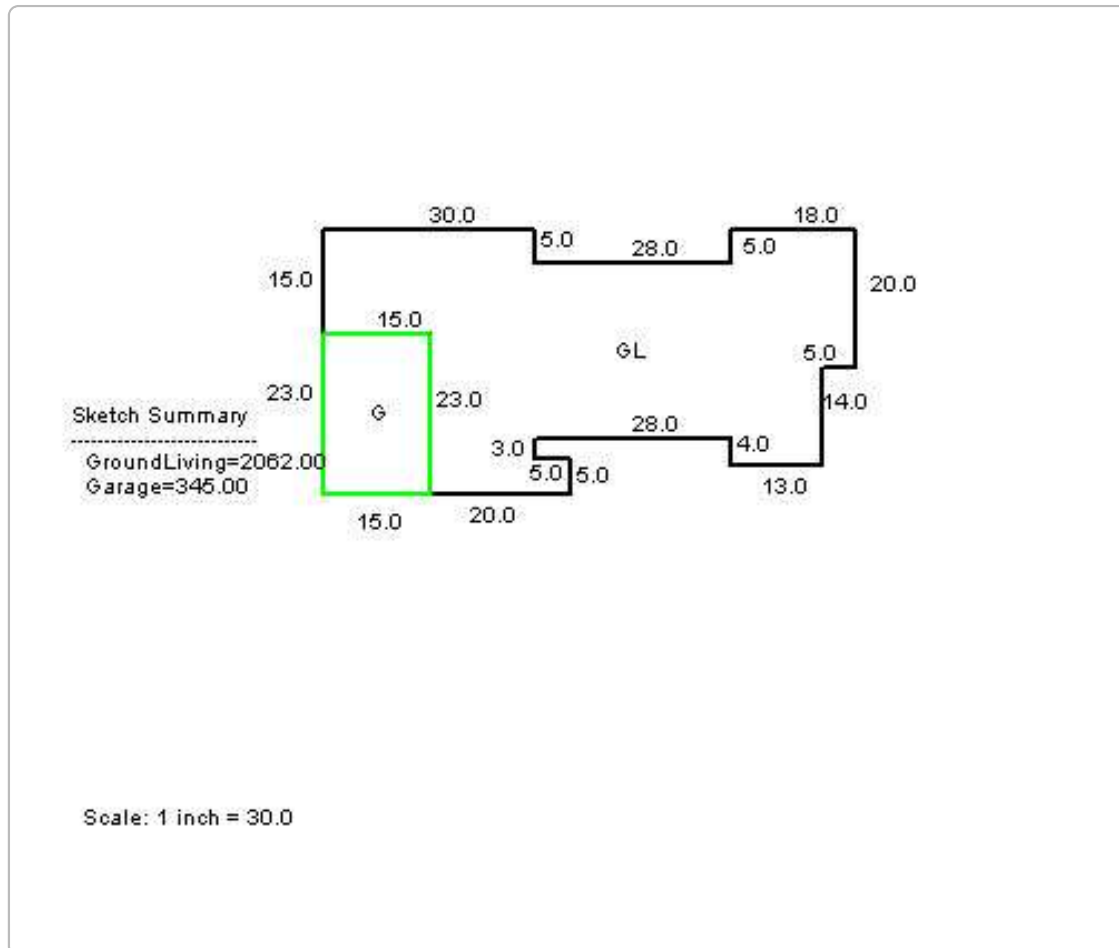

No data available for the following modules: Commercial Improvements.

The Christian County Assessor's Office makes every effort to produce the most accurate information possible. No warranties, expressed or implied, are provided for the data herein, its use or interpretation.

| [User Privacy Policy](#) | [GDPR Privacy Notice](#)  
[Last Data Upload: 7/19/2024, 12:19:29 PM](#)

Contact Us

Developed by

