

The following dimensions are approximate interior wall to wall dimensions, measured on site, from the widest portion of each room, then calculated to Feet/Inches from Rounded Decimal Feet. Information deemed reliable, but not guaranteed.

Room Dimension Summary	Address:	4147 Siler City Snow Camp Road Siler City, NC 27344					
	Prepared for	Eric Andrews	Measured by	Laura Fuelleman			

The following dimensions are approximate interior wall to wall dimensions, measured from the widest portion of each room.
Information deemed reliable, but not guaranteed.

	Length in Feet - Parallel to Front Facade	Width in Feet - Perpendicular to Front Facade	Parallel to Front Facade			Perpendicular to Front Facade	
	Decimal Feet		Calculated Feet/Inches from Rounded Decimal Feet				
Main House							
Foyer	7.7	3.2	7 ft	8 in	by	3 ft	2 in
Dining Room	17.6	13.7	17 ft	7 in	by	13 ft	8 in
Living Room	12.7	16.3	12 ft	8 in	by	16 ft	4 in
Informal Dining	8.9	6.2	8 ft	11 in	by	6 ft	2 in
Kitchen	10.9	9.8	10 ft	11 in	by	9 ft	10 in
Primary Bedroom	14.3	29.7	14 ft	4 in	by	29 ft	8 in
Primary Bathroom	9.6	8.6	9 ft	7 in	by	8 ft	7 in
Walk in Closet	5.5	6.8	5 ft	6 in	by	6 ft	10 in
Bedroom	13.8	10	13 ft	10 in	by	10 ft	0 in
Bathroom	5	9.9	5 ft	0 in	by	9 ft	11 in
Laundry Room	5.9	9.9	5 ft	11 in	by	9 ft	11 in
Front Porch	27.5	7	27 ft	6 in	by	7 ft	0 in
Enclosed Breezeway	7.2	20.6	7 ft	2 in	by	20 ft	7 in
Garage	13.8	20.8	13 ft	10 in	by	20 ft	10 in
Deck	9.5	18.6	9 ft	6 in	by	18 ft	7 in
Patio	19.4	24.9	19 ft	5 in	by	24 ft	11 in
Gazebo	11.1	11.1	11 ft	1 in	by	11 ft	1 in

	Decimal Feet		Feet/Inches				
Caribbean Woods Cottage							
Main Area	19.4	15	19 ft	5 in	by	15 ft	0 in
Bathroom	5.9	6.2	5 ft	11 in	by	6 ft	2 in
Loft	4.8	15	4 ft	10 in	by	15 ft	0 in
Deck	16.1	8	16 ft	1 in	by	8 ft	0 in
Covered Porch	20.1	4	20 ft	1 in	by	4 ft	0 in
Lower Bar	13.4	17.9	13 ft	5 in	by	17 ft	11 in
Lower Patio	15.1	15.1	15 ft	1 in	by	15 ft	1 in
Also has an Outdoor Shower							

	Decimal Feet		Calculated Feet/Inches from Rounded Decimal Feet				
Rainforest Retreat							
Main Area	28.2	11.3	28 ft	2 in	by	11 ft	4 in
Bathroom	4.4	7.6	4 ft	5 in	by	7 ft	7 in
Outdoor Shower	4	4	4 ft	0 in	by	4 ft	0 in
Deck	10.5	10	10 ft	6 in	by	10 ft	0 in
Creek Deck	6.3	8.3	6 ft	4 in	by	8 ft	4 in

	Decimal Feet		Calculated Feet/Inches from Rounded Decimal Feet				
Detached Garages, Bunkhouse & Potting Shed							
Garage 1 / Workshop	11.5	20.7	11 ft	6 in	by	20 ft	8 in
Bunkhouse	8.8	20.3	8 ft	10 in	by	20 ft	4 in
Garage 2	21	13.8	21 ft	0 in	by	13 ft	10 in
Potting Shed	20.8	11.9	20 ft	10 in	by	11 ft	11 in
Porch	6	8	6 ft	0 in	by	8 ft	0 in

Side Shelter	20.9	20.9	20 ft	11 in	by	20 ft	11 in
Grand Getaway							
	Decimal Feet		Calculated Feet/Inches from Rounded Decimal Feet				
Left Area	24	23.9	24 ft	0 in	by	23 ft	11 in
Right Area	38.7	38.8	38 ft	8 in	by	38 ft	10 in
Kitchen-Laundry	13.4	10.2	13 ft	5 in	by	10 ft	2 in
Bathroom	10	6	10 ft	0 in	by	6 ft	0 in
Outdoor Shower	6	5.6	6 ft	0 in	by	5 ft	7 in
Left Porch	24.7	7.4	24 ft	8 in	by	7 ft	5 in
Right Porch	11.4	6.5	11 ft	5 in	by	6 ft	6 in
Back Deck	8	8	8 ft	0 in	by	8 ft	0 in
Shelter	12.3	39.5	12 ft	4 in	by	39 ft	6 in
Left Shed	24	11	24 ft	0 in	by	11 ft	0 in
Right Shed	9.8	20	9 ft	10 in	by	20 ft	0 in
Other Areas							
	Decimal Feet		Calculated Feet/Inches from Rounded Decimal Feet				
Lakeside Deck	12	12	12 ft	0 in	by	12 ft	0 in
Old Barn - Enclosed Area	30	26	30 ft	0 in	by	26 ft	0 in
Old Barn has approx 12.5 ft shelter wrap around most of exterior							

Sketch

Case Number: 20240916-2 File Number:
 Address: 4147 Siler City Snow Camp Road
 City / State: Siler City / NC Zip / County: 27344 /
 Borrower:
 Lender or Client: Eric Andrews
 Prepared By: Laura Fuelleman

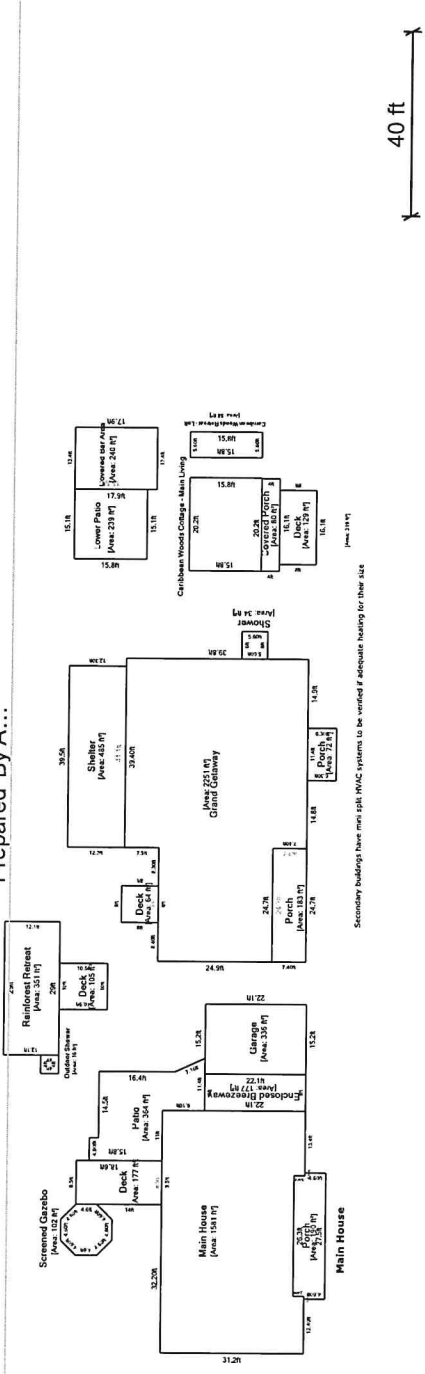

Secondary bedrooms have min. 5sq. HVAC systems to be verified if adequate heating for their size.



Living Area	
Main House	1581.12 ft²
Grand Getaway	2250.81 ft²
Rainforest Retreat	350.90 ft²
Carribean Woods Cottage - Main Living	319.16 ft²
Nonliving Area	
Porch	189.62 ft²
Deck	176.70 ft²
Screened Gazebo	102.17 ft²
Patio	363.71 ft²
Enclosed Breezeway	176.80 ft²
Garage	335.92 ft²
Porch	182.78 ft²
Deck	64.00 ft²
Porch	71.82 ft²
Showers	33.60 ft²
Shelter	485.23 ft²
Deck	105 ft²
Carribean Woods Retreat - Loft	88.48 ft²
Outdoor Shower	16.00 ft²
Lower Patio	238.58 ft²
Covered Bar Area	239.86 ft²
Covered Porch	80.40 ft²
Deck	128.80 ft²
Total Living Area (rounded):	4502 ft²
Total Non-Living Area (rounded):	3079 ft²

This document is designed to be a record of total finished square feet to aid the listing agent in gathering the square feet facts of the property. Measurements are obtained by physical observation of the property by a certified Home Measurement Specialist. The method of measuring the subject home is in accordance with the NC Residential Square Footage Guidelines and those approved by the American National Standards Institute, Inc (ANSI), which are recognized by the North Carolina Real Estate Commission as comparable standards. Within every measurement project, some degree of art of opinion may be applied as well as rounding as set forth in the standards. Final finished square footage will be rounded to the nearest whole number with the goal of being within a 5% margin of error. Information deemed reliable, but not guaranteed.



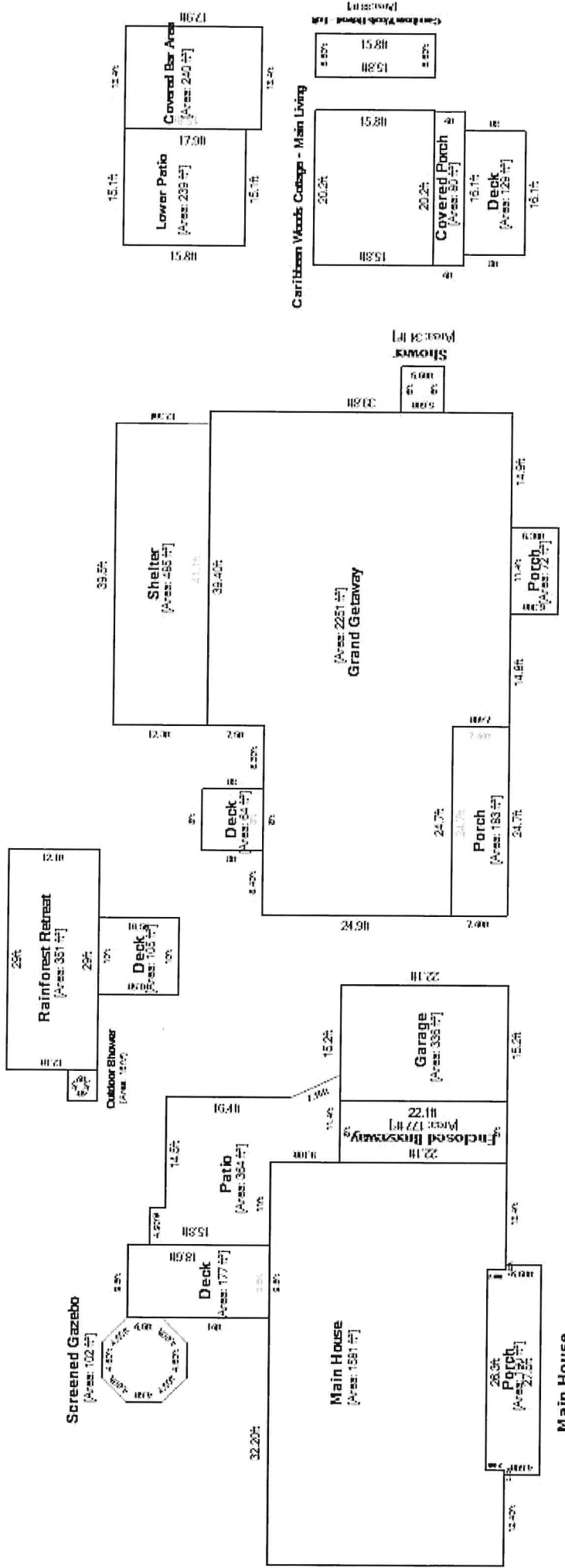

Secondary buildings have mini split HVAC systems to be verified. If accurate heating for their size