

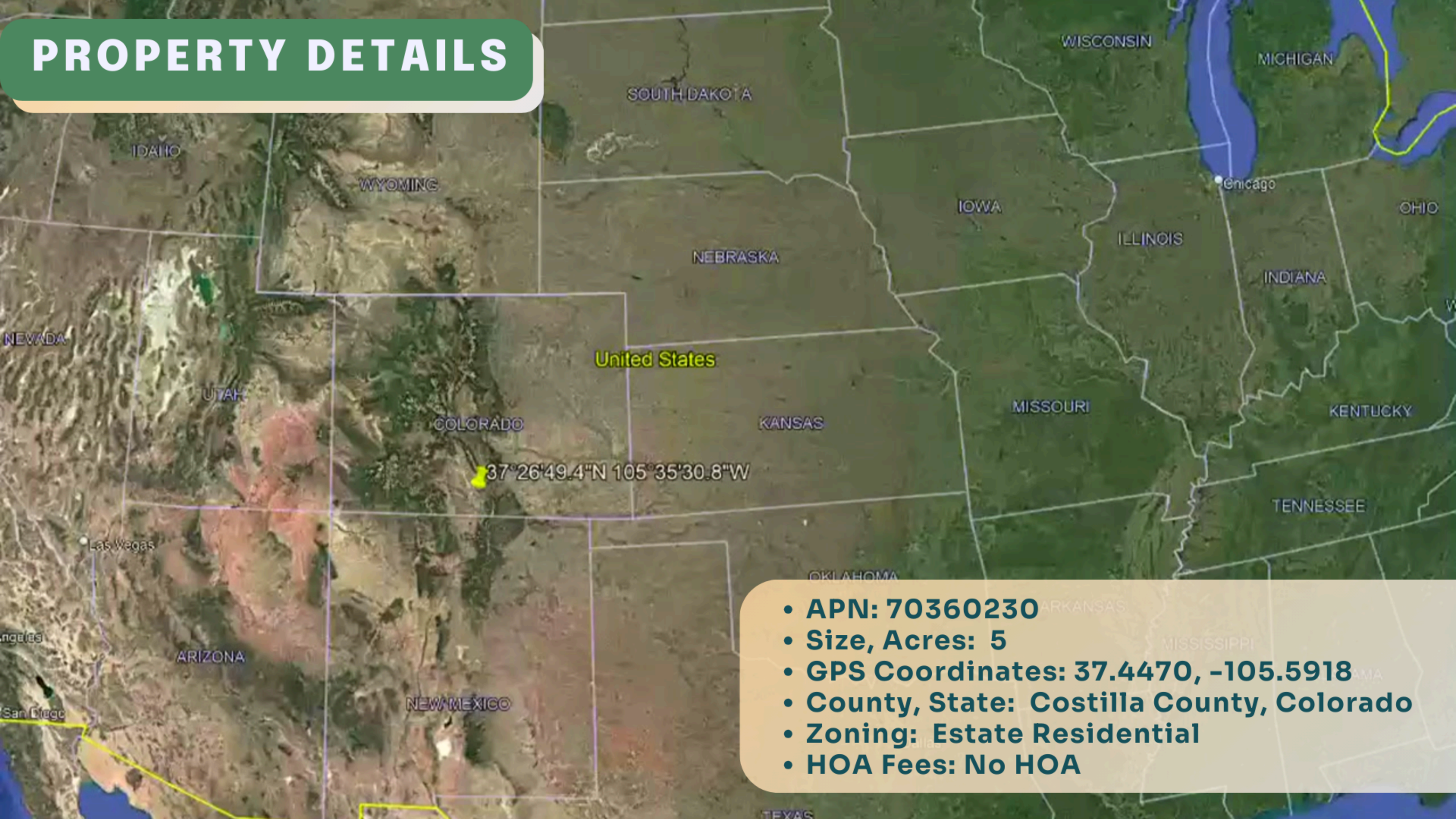

5 acres in beautiful Colorado!
\$247 down payment \$147/month

PROPERTY DETAILS



United States

37°26'49.4"N 105°35'30.8"W

- **APN: 70360230**
- **Size, Acres: 5**
- **GPS Coordinates: 37.4470, -105.5918**
- **County, State: Costilla County, Colorado**
- **Zoning: Estate Residential**
- **HOA Fees: No HOA**

CLIMATE



Summer High:

The July high is around 92 degrees



Winter Low:

The January low is 30



Rain:

Averages 54 inches of rain a year



Snow:

Averages 4 inches of snow a year



 28 min
21 miles

28 MIN (21 MILES)

THIS PROPERTY IS 28 MIN (21 MILES) TO WALMART SUPERCENTER IN ALAMOSA, CO.

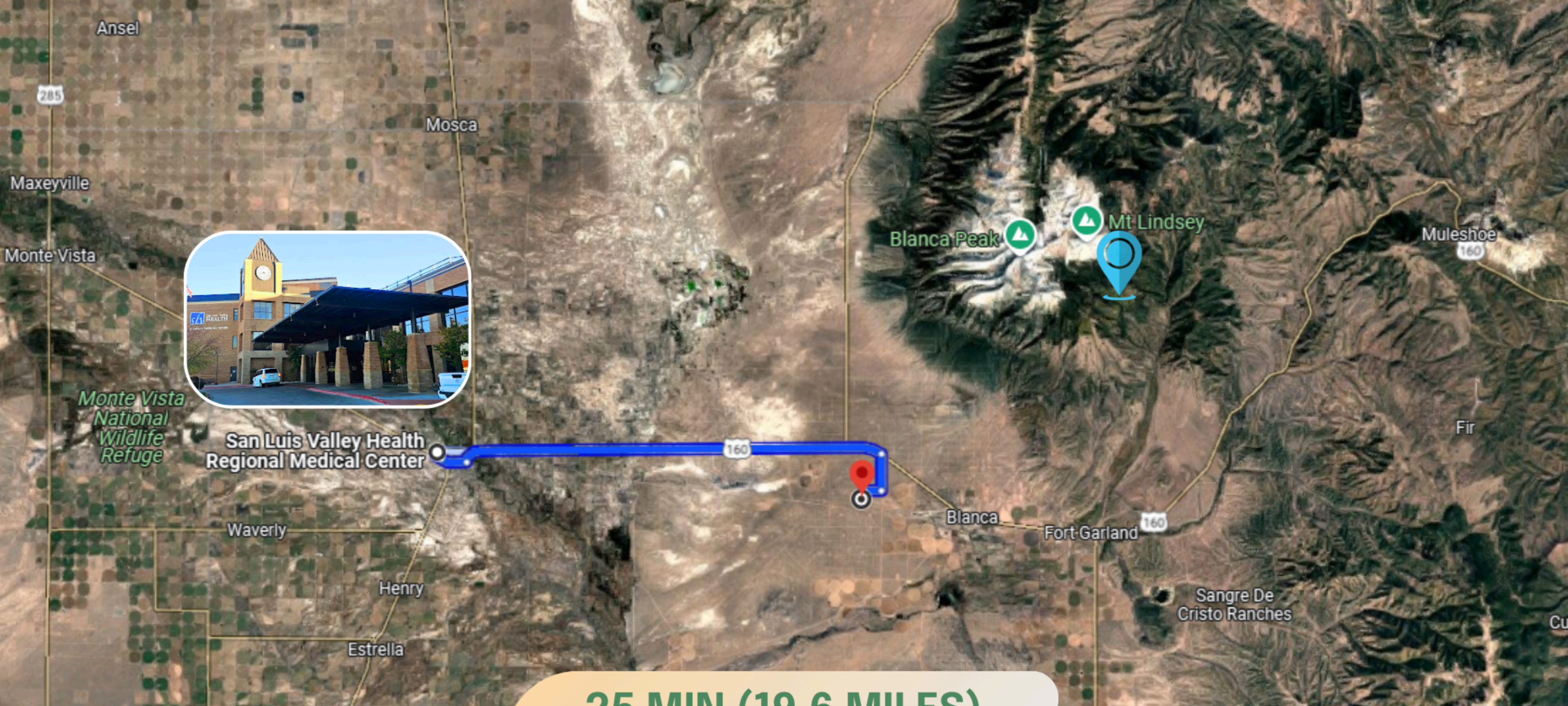

25 MIN (19.6 MILES)

**THIS PROPERTY IS 25 MIN (19.6 MILES) TO SAN LUIS VALLEY HEALTH REGIONAL MEDICAL CENTER
IN ALAMOSA, CO.**



21 MIN (19.7 MILES)

THIS PROPERTY IS 21 MIN (19.7 MILES) TO GREAT SAND DUNES NATIONAL PARK AND PRESERVE IN DUNCAN, CO.

A photograph of two men shaking hands in a field at sunset. The man on the left is wearing a light-colored vest over a blue shirt and has a backpack. The man on the right is wearing a plaid shirt over a white t-shirt, glasses, and a watch, and is holding a tablet. The background is a field of yellow flowers under a warm, golden sky.

We pride ourselves in making sure the process is **simple, quick** and **stress-free** for you!

We offer **easy financing** as well as a **discounted cash price!**





VISIT US FOR MORE PROPERTY LISTINGS

Q <https://lifetimelandusa.com>



YOU MAY ALSO REACH US AT:

 682-382-9719

 sales@lifetimelandusa.com

 Lifetime Land USA

 lifetimeland_usa

*Our mission is to
turn your dream
of becoming a
landowner into
a reality.*