

Soils Map

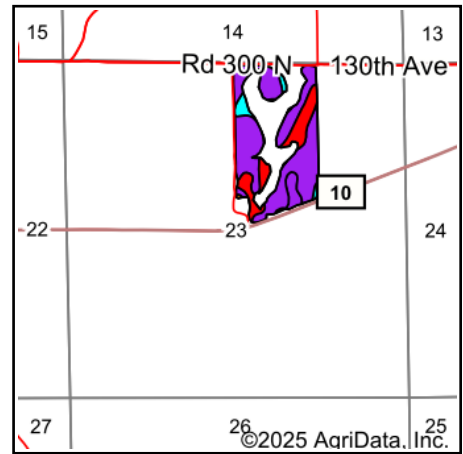

State: **Illinois**
 County: **Pike**
 Location: **23-7S-4W**
 Township: **Pleasant Hill**
 Acres: **46.6**
 Date: **1/13/2025**

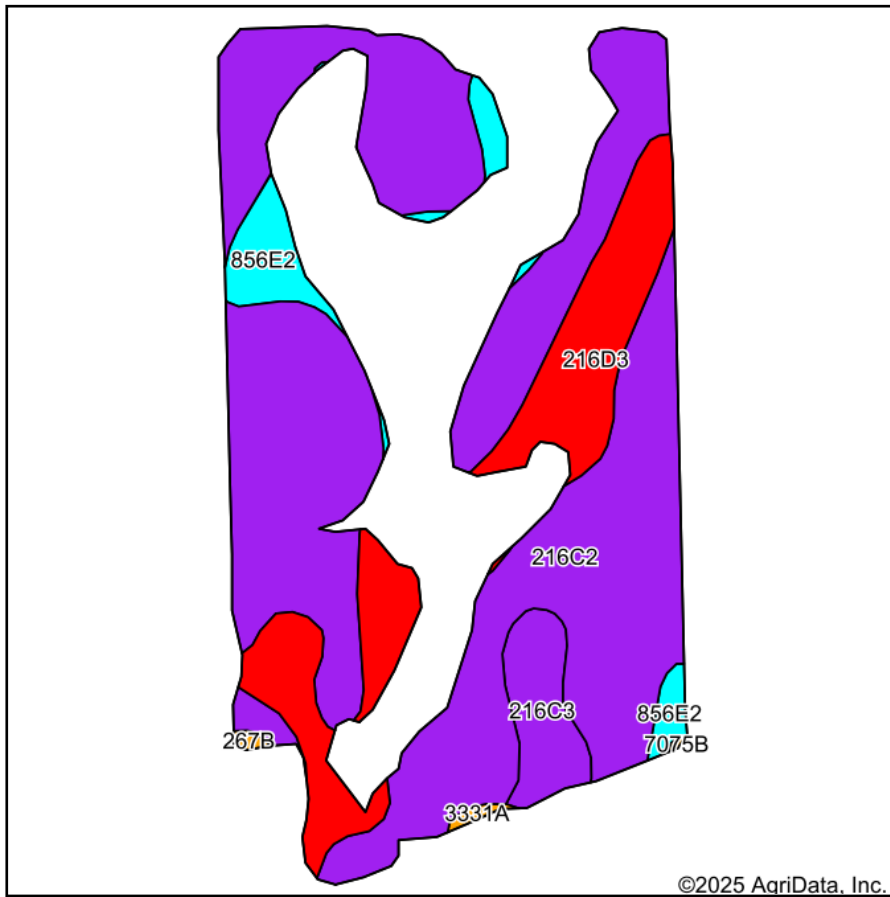

Maps Provided By:



Soils data provided by USDA and NRCS.

©2025 AgriData, Inc.

Area Symbol: IL149, Soil Area Version: 19

Code	Soil Description	Acres	Percent of field	Il. State Productivity Index Legend	Subsoil rooting a	Corn Bu/A	Soybeans Bu/A	Wheat Bu/A	Oats Bu/A b	Sorghum c Bu/A	Grass-le gume e hay, T/A	Crop productivity index for optimum management	*n NCCPI Soybeans
**216C2	Stookey silt loam, 5 to 10 percent slopes, eroded	33.35	71.5%		FAV	**149	**46	**55	0	**110	**4.10	**107	73
**216D3	Stookey silt loam, 10 to 18 percent slopes, severely eroded	8.38	18.0%		FAV	**126	**39	**47	0	**93	**3.50	**91	55
**856E2	Stookey and Timula soils, 18 to 25 percent slopes, eroded	2.47	5.3%		FAV	**120	**38	**45	**28	**45	**3.00	**87	45
**216C3	Stookey silt loam, 5 to 10 percent slopes, severely eroded	2.19	4.7%		FAV	**138	**42	**51	0	**101	**3.80	**99	56



Code	Soil Description	Acres	Percent of field	Il. State Productivity Index Legend	Subsoil rooting a	Corn Bu/A	Soybeans Bu/A	Wheat Bu/A	Oats Bu/A b	Sorghum c Bu/A	Grass-legume e hay, T/A	Crop productivity index for optimum management	*n NCCPI Soybeans
**3331A	Haymond silt loam, 0 to 2 percent slopes, frequently flooded	0.12	0.3%		FAV	**163	**50	**63	**83	0	**5.20	**119	80
**267B	Caseyville silt loam, 2 to 5 percent slopes	0.09	0.2%		FAV	**169	**51	**64	0	**123	**5.20	**125	78
Weighted Average						142.9	44.1	52.9	1.7	102.8	3.9	102.8	*n 67.5

Table: Optimum Crop Productivity Ratings for Illinois Soil EFOTG are sourced from Bulletin 811 calculated Map Unit Base Yield Indices, and adjusted (Adj) for slope, erosion, flooding, and surface texture. Publication Date: 02-08-2023

Crop yields and productivity (B811 EFOTG) are maintained at the following USDA web site: 2023 Illinois Soil Productivity and Yield Indices: <https://efotg.sc.egov.usda.gov/#/state/IL/documents/section=2&folder=52809>

** Base indexes from Bulletin 811 adjusted for slope, erosion, flooding, and surface texture according to the Il. Soils EFOTG

b Soils in the southern region were not rated for oats and are shown with a zero "0".

c Soils in the northern region or in both regions were not rated for grain sorghum and are shown with a zero "0".

e Soils in the well drained group were not rated for grass-legume and are shown with a zero "0".

*n: The aggregation method is "Weighted Average using all components"