

Overview

Parcel Number	0017322	FMV	224,594
Tax Year	2024	Exemption/Exclusion	0
Class	R - RESIDENTIAL	Deferred	0
Physical Address	471 DEER RUN NC	ASV	224,594
Acreage	4.9200	Tax Rate	0.8530
		Total Tax	\$2,052.79

Tax Disbursements

Jurisdiction	Tax Rate	Tax Amount
CHATHAM COUNTY	0.7250	\$1,628.31
NORTH CHATHAM FIRE DIST	0.1280	\$287.48
CHATHAM COUNTY AVF	0.0000	\$137.00
<b>TOTAL</b>		<b>\$2,052.79</b>

Photos & Sketches

Converted Sketch

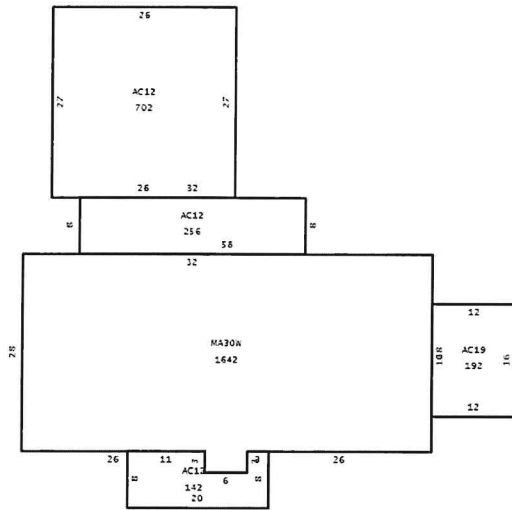

⊖ Billing

	Total
<b>Tax Billed</b>	\$1,915.79
<b>SA Billed</b>	\$0.00
<b>Interest Billed</b>	\$0.00
<b>Fees Billed</b>	\$137.00
<b>Total Billed</b>	\$2,052.79
<b>Amount Paid</b>	\$2,052.79
<b>Total Unpaid</b>	<b>\$0.00</b>
<b>Date Paid</b>	11/21/2024
<b>Paid By</b>	ROCKET MORTGAGE, LLC

⊖ Tax Due Amounts

If paid in...	Amount due is...
December 2024	\$0.00

Pay Taxes

Tax Due amounts are for all unpaid years.  
See Payment History section for year-by-year details.

⊖ Payment History

Tax Year	Total Due	Total Paid	Amount Unpaid	Date Paid
2024	\$2,052.79	\$2,052.79	\$0.00	11/21/2024
2023	\$1,962.95	\$1,962.95	\$0.00	11/29/2023
2022	\$1,883.57	\$1,883.57	\$0.00	11/17/2022
2021	\$1,861.11	\$1,861.11	\$0.00	8/11/2021
2020	\$1,592.34	\$1,592.34	\$0.00	11/13/2020

Show 5 More (22)

Zoning

Code	Classification
R-1	RESIDENTIAL DISTRICT 1
R-1	RESIDENTIAL DISTRICT 1

⊖ Legal

Legal Description	Subdivision Name	Block	Lot	Plat Book	Plat Page
LOT #16R					

No Exclusions

➤ Owner Information

**OWNER** HARVEL PAUL WILSON IV,  
**Mailing Address** 471 DEER RUN  
PITTSBORO, NC 273125437

➤ Transfer History

Book & Page	Sale Type	Sale Date	Sold By	Sold To	Price
2282 0933	WARRANTY DEED	2/8/2022	HARVEL PAUL WILSON IV HEARNE ANN HARVEL	HARVEL PAUL WILSON IV	\$0
1849 0377	WARRANTY DEED	4/1/2016	HARVEL MARJORIE ANN CLARK	HARVEL PAUL WILSON IV HEARNE ANN HARVEL	\$0
993 0162	COMBINE	3/8/2016		HARVEL MARJORIE ANN CLARK HARVEL ANNE C	\$0
993 0162	SPLIT	6/30/2005		HARVEL MARJORIE ANN CLARK	\$0
993 0162	QUIT CLAIM DEED	2/3/2003	HARVEL MARJORIE ANN CLARK	HARVEL MARJORIE ANN CLARK	\$0
458 0433		12/31/1996		HARVEL PAUL WILSON HARVEL ANNE C	\$0

No Genealogy

➤ Land Value

Property Class	Valued Acres	Appraised Value
Acre - Residual	3.9200	52,920
Acre - Primary	1.0000	70,200

☰ CAMA - Structure (1 of 2) - Real Estate

Property Class	Description	Total Finished Area	Year Built
RES - Residential	MANUFACTURED	1,642	1986
<b>House Type</b> MANUFACTURED		<b>Accommodations</b> Number of Bathrooms 2.00 Number of Stories 1.00 Number of Rooms 6.00 Number of Bedrooms 2.00 Number of Half Bathrooms 0.00	
<b>Porches/Decks</b> AC12R - Deck - Frame 142 Square Ft. AC12R - Deck - Frame 702 Square Ft. AC12R - Deck - Frame 256 Square Ft. AC19R - Porch - Half Screened 192 Square Ft.		<b>Fireplace</b> FP03R - Prefabricated 1.00	
<b>Base Cost</b> 30W - Wood Frame - Main Floor 1,642 Square Ft.		<b>Foundation Type</b> FN03 - Continuous Slab 1,642 Square Ft.	
<b>Exterior Wall</b> Alum/Vinyl 90 Percent Wood Siding 10 Percent		<b>Heating &amp; Cooling</b> HC07 - Packaged Heat/Cool 1,642 Square Ft.	

☰ CAMA - Structure (2 of 2) - Real Estate

Property Class	Description	Total Finished Area	Year Built
RES - Residential	Outbuildings Only - RES	0	2023
<b>Storage</b> MS28R - Storage Bldg. Unfinished 630 Square Ft. Year Built: 2000 MS28R - Storage Bldg. Unfinished 160 Square Ft. Year Built: 1995		<b>Carport/Garage</b> MS81R - Car Shed Pole 630 Square Ft. Year Built: 1995	
		<b>Shed</b> MS23R - Shed Open Pole 144 Square Ft. Year Built: 1995 MS48R - Lean-to/Shelter 128 Square Ft. Year Built: 1995	

☰ Market Value

Year	Market Land	Market Building	Market Total
2024	123,120	101,474	224,594
2023	123,120	101,474	224,594

Contact Information

**Chatham County Tax Assessor**

12 East Street  
PO Box 908  
Pittsboro, NC 27312  
Phone: 919-542-8211

**Chatham County Tax Collector**

192 West Street  
PO Box 697  
Pittsboro, NC 27312  
Phone: 919-542-8260