

INVOICE

Please read the important information on page two of this form.



KK Enterprises
Kurt Kramer
 PO Box 225
 Volcano, CA 95689
 209-419-0971 / 209-296-1611
 Contractor's License No: 824191
 www.excavation4u.com

JOB INFORMATION

CONTRACT NO. 2020-13818	DATE 2/26/2020	JOB Madrone Ct		
PROPOSAL SUBMITTED TO [REDACTED]		APN 031-344-002		
PHONE [REDACTED]	FAX	JOB OWNER [REDACTED]	JOB FAX	
EMAIL [REDACTED]		JOB STREET ADDRESS 0 Old Madrone Ct		
JOB OWNER Renee Martin		CITY Pinoneer	STATE CA	ZIP 95666

JOB DESCRIPTION

The undersigned proposes to furnish all materials and perform all labor necessary to complete the following work of improvement with the plans and specifications attached hereto, and by reference incorporated herewith:

Install a Three bedroom septic system only- Price doesn't include final hookup to house or shop
Price includes cutting brush and trees as needed, slash to be left on property. Not responsible for disturbance of landscaping.
Not responsible for property lines and setbacks, owner to locate.
Will call USA prior to digging, not responsible for damage to utilities, marked or unmarked, if any.
Rock, poor soil conditions, tree stumps, unknown dump site, water or any other unforeseen conditions encountered during excavation may occur.

AGREEMENT AND TERMS OF PAYMENT

START DATE Within 30 days of acceptance, weather permitting.	CONTRACT PRICE \$8,500.00	PAYMENT SCHEDULE Total due.
--	-------------------------------------	---------------------------------------

All of the above work is to be completed in a substantial and workmanlike manner according to standard practices on or before the date specified, save and except for any delays caused by strikes, acts of God or other unforeseen happenstances over which the Contractor has no control. Any alteration or deviation from the above specifications involving extra cost of material or labor will only be executed upon written orders for the same, and will become an extra charge over the sum mentioned in this contract. All agreement must be made in writing. This proposal shall be binding upon the Contractor for a period not to exceed 30 days, unless earlier revoked by written notice of revocation prior to acceptance, at which time this Proposal shall terminate automatically. No contractual rights arise until this Proposal is accepted in writing. Owner to carry fire, tornado and other necessary insurance upon above work.

This Proposal is hereby accepted according to the terms thereof and Owner agrees to pay the amounts mentioned in said Proposal and according to the terms thereof.

X _____
 Signature/Acceptance of Owner Date

23960 Old Machine Rd.

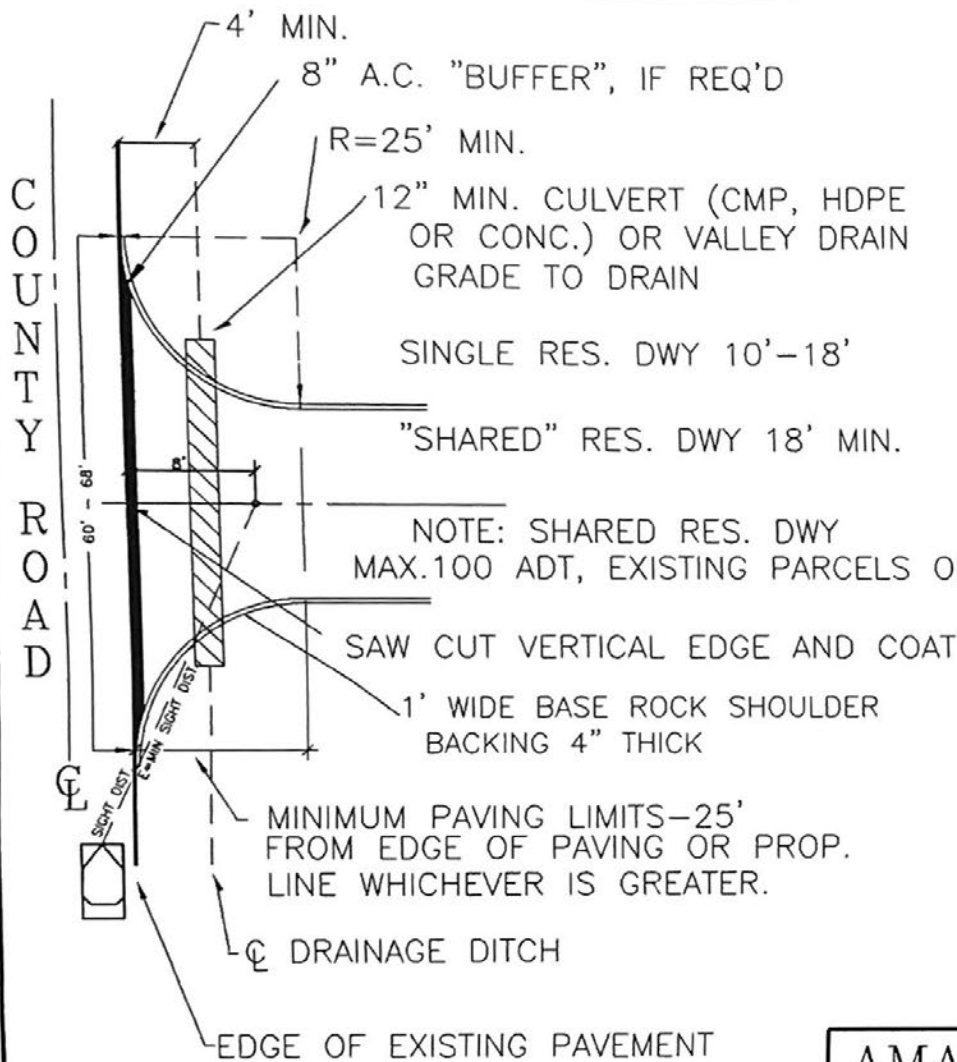

NOTES:

1. Approach shall be constructed from one of the following:
 - A. 2" A.C. over 4" class II aggregate base (A.B.).
 - *B. 5" concrete (2500 psi) with 6" x 6" #10 gauge wire mesh placed in upper 1/3 of concrete or Nikon fibermesh over 2" compacted class II A.B.
 - C. Alternate design suggested or approved by the Public Works Agency.

Subgrade inspection is required before placing Aggregate Base. Min. 2 working days advance notice.

A base rock inspection is required before placing concrete or asphalt. Min. 2 working days advance notice.
2. Erosion protection shall be provided as required by the Public Works Agency.
3. Easements, for excavation on adjacent property, are the responsibility of the permittee.
4. All work shall be in conformance of the County's Standard Plan PW-3 and Caltrans Standard Specifications.
5. Driveway approach shall be at 90° or as near to 90° to the road as possible.
6. Driveway approach shall be in a min. of 150' from an intersection.
7. E=10 times operational speed on County roads, both directions. 100 ft. min. sight dist. for a cul-de-sac, both directions.
8. No portion of driveway shall be within 50 ft. from a radius return nor 10 ft. from a fire hydrant.
 - * Concrete driveway may not be acceptable under certain circumstances.

PERPETUAL MAINTENANCE IS THE RESPONSIBILITY OF THE PROPERTY OWNER

AMADOR COUNTY



PUBLIC WORKS AGENCY

STANDARD RESIDENTIAL DRIVEWAY APPROACH STD. PLAN PW-4

SCALE: N.T.S. DATE: 10/30/95 REV.: 08/08/06 ADOPT: 03/03/97

DRAWN BY: B. S.

APPROVED BY: LARRY PETERSON, P.E.

FILE NO. PW-4.DWG

CHECKED BY: L. PETERSON

Larry S. Peterson
DIRECTOR OF PUBLIC WORKS

SHT 1 OF 1

ENCROACHMENT PERMIT

AMADOR COUNTY DEPT. OF TRANSPORTATION AND PUBLIC WORKS
 810 COURT STREET, JACKSON CA 95642-2132
 PH. (209) 223-6429 FAX (209) 223-6395



Code: **D**

Permit No. **20014**

Permit Fee:

Mailbox \$25.00

Encroachment \$625.00

Utility Encroachment \$625.00 plus actual inspection costs if more than \$625.00

Other - Fee to be determined

BASE ROCK INSP.

DATE: _____ BY: _____

FINALED: _____ BY: _____

Driveway Completion Agreement Performance Security

(Amount As Required) **\$2100**

TOTAL DUE: PAID

The County of Amador, State of California, hereby authorizes and grants a revocable license to:

FIRST NAME	LAST NAME	PHONE
MAILING ADDRESS	CITY	STATE ZIP
APN: 031-344-002	COUNTY ROAD OLD MADRONE RD.	SITUS 23960 P M LT/RT
LOCATION OF ENCROACHMENT: 23960 OLD MADRONE RD.		
TYPE OF ENCROACHMENT: STANDARD RESIDENTIAL DRIVEWAY		
START DATE 2/25/2020	EXPIRATION DATE 2/25/2021	EXTENSION DATE

This Permit is VOID if not completed by the above completion date. A time extension may be requested.

PERMIT CONDITIONS:

- CONSTRUCT A STANDARD RESIDENTIAL DRIVEWAY AS MARKED IN THE FIELD WITH GRADE TO DRAIN.

NOTIFY THIS OFFICE 48 HOURS PRIOR TO THE COMMENCEMENT OF ANY WORK.

Please have your permit number when contacting this office. For and in consideration of the granting of this permit, the permittee promises and agrees to comply with all provisions of the Amador County Ordinance, standards and policies enacted pursuant thereto, the provisions of this permit and all attachments.

PERPETUAL MAINTENANCE OF THE ENCROACHMENT IS THE RESPONSIBILITY OF THE PERMITTEE.

FUTURE MOVING OF INSTALLATION: It is understood and agreed by the permittee that whenever construction, reconstruction, or maintenance work on the highway may require it, that the installation herein provided for, shall upon request of the Grantor, be immediately moved by and at the sole expense of the permittee.

All work shall be done in accordance to Amador County minimum standards and the standards and details shown on the attached sheets:

- SHEET NO. ATTACHMENT:
- P.W.-3
 - P.W.-4
 - GENERAL CONDITIONS
 -
 -
 -
 -
 -
 -

JERED REINKING, DIRECTOR OF PUBLIC WORKS

By: _____

2/25/2020

DATE:

INSPECTOR: Jack O'Brien

AMADOR COUNTY SURVEYING DEPARTMENT
810 Court Street, Jackson, CA 95642-2132 Phone 209/223-6371, Fax 209-257-5022

STREET ADDRESS APPLICATION

DATE 2-25-2020 FEE: \$25.00 PER ADDRESS

NAME OF OWNER [REDACTED]

NAME OF APPLICANT [REDACTED]

ASSESSOR PARCEL NUMBER 031-344-002-000

[Signature] [REDACTED]
SIGNATURE OF APPLICANT Phone Number

SKETCH MAP OF DRIVEWAY LOCATION (CAN USE SEPARATE SHEET OR ASSESSOR MAP)

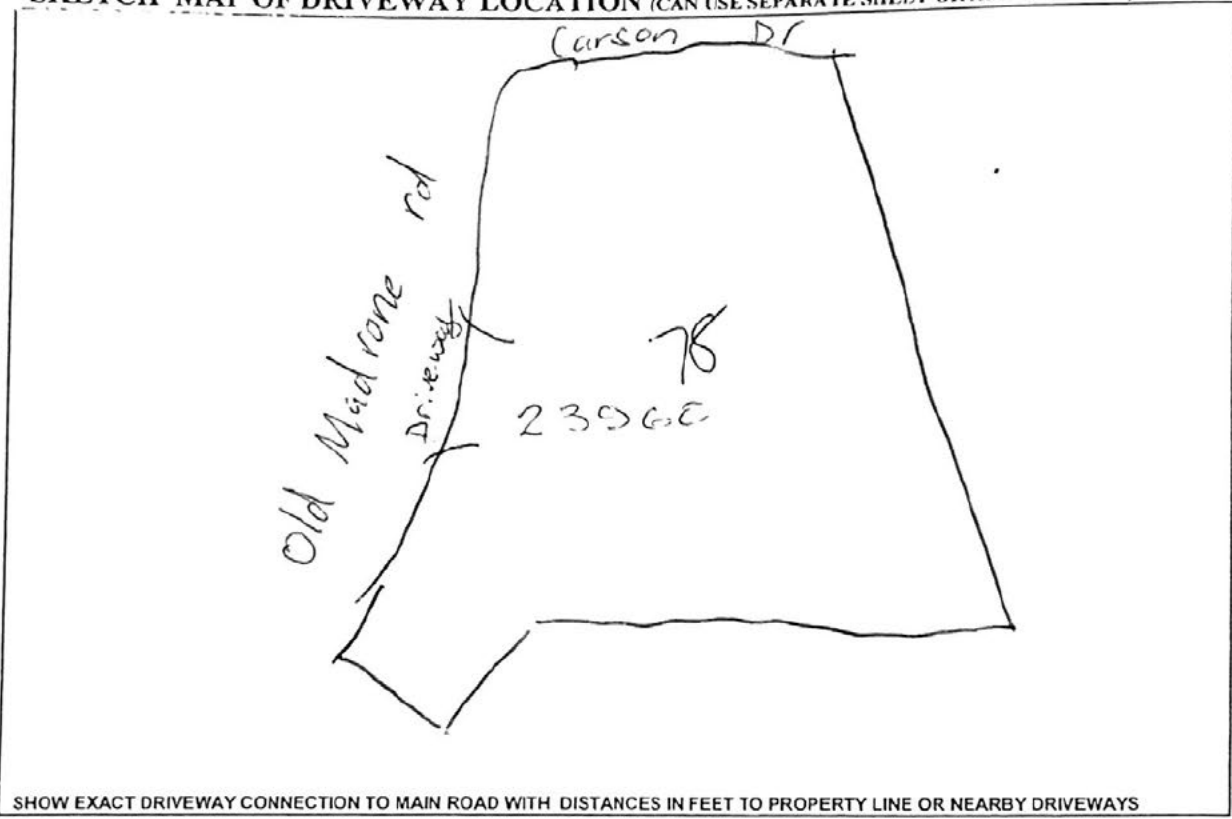

FEE PAID: \$25.00 CASH CHECK#

ADDRESS # ISSUED 23966 OLD MADRONE RD

[Signature]
COUNTY SIGNATURE

INVOICE

Please read the important information on page two of this form.



KK Enterprises
Kurt Kramer
 PO Box 225
 Volcano, CA 95689
 209-419-0971 / 209-296-1611
 Contractor's License No: 824191
 www.excavation4u.com

JOB INFORMATION

CONTRACT NO. 2020-13818	DATE 3/23/2020	JOB Madrone Ct	
PROPOSAL SUBMITTED TO [REDACTED]		APN 031-344-002	
PHONE [REDACTED]	FAX	JOB OWNER [REDACTED]	JOB FAX
EMAIL [REDACTED]		JOB STREET ADDRESS 0 Old Madrone Ct	
JOB OWNER [REDACTED]		CITY Pioneer	STATE CA
			ZIP 95666

JOB DESCRIPTION

The undersigned proposes to furnish all materials and perform all labor necessary to complete the following work of improvement with the plans and specifications attached hereto, and by reference incorporated herewith:

- Price Includes Climbing and piecing down necessary Trees
- Price includes cutting brush and trees as needed, slash to be left on property. Not responsible for disturbance of landscaping.
- Not responsible for property lines and setbacks, owner to locate.
- Will call USA prior to digging, not responsible for damage to utilities, marked or unmarked, if any.
- Rock, poor soil conditions, tree stumps, unknown dump site, water or any other unforeseen conditions encountered during excavation may occur.
- Price includes removal and disposal of trees, Excavating stumps in house pad area only brush will be left for Owner to dispose of.

AGREEMENT AND TERMS OF PAYMENT

START DATE Within 30 days of acceptance, weather permitting.	CONTRACT PRICE \$5,800.00	PAYMENT SCHEDULE Total due
--	-------------------------------------	--------------------------------------

All of the above work is to be completed in a substantial and workmanlike manner according to standard practices on or before the date specified, save and except for any delays caused by strikes, acts of God or other unforeseen happenstances over which the Contractor has no control. Any alteration or deviation from the above specifications involving extra cost of material or labor will only be executed upon written orders for the same, and will become an extra charge over the sum mentioned in this contract. All agreement must be made in writing. This proposal shall be binding upon the Contractor for a period not to exceed 30 days, unless earlier revoked by written notice of revocation prior to acceptance, at which time this Proposal shall terminate automatically. No contractual rights arise until this Proposal is accepted in writing. Owner to carry fire, tornado and other necessary insurance upon above work.

This Proposal is hereby accepted according to the terms thereof and Owner agrees to pay the amounts mentioned in said Proposal and according to the terms thereof.

x *[Signature]*
 Signature/Acceptance of Owner _____ Date _____

APPLICATION FOR ENCROACHMENT PERMIT

810 Court Street • Jackson, CA 95642 • Phone: 209-223-6429 • Fax: 209-223-6395
 e-mail: publicworks@amadorgov.org • website: www.amadorgov.org



Jack O'Brien

Joel Riley

ext. 236

OWNER NAME: [REDACTED]
 MAILING ADDRESS: [REDACTED]
 PHONE # [REDACTED] EMAIL: [REDACTED]

APPLICANT/CONTRACTOR NAME (if other than owner)
 MAILING ADDRESS: 19501 Deerwood Pl, Volcano 95689
 PHONE # 419-0971 EMAIL: Kurt.Kramer-21@gmail.com

PROJECT LOCATION: 23940 Old Madrone Rd. Pioneer 95664
 PARCEL # 031-344-002-000

DRIVING DIRECTIONS TO SITE:
 IS ENCROACHMENT A PROJECT CONDITION FOR ANY OF THE FOLLOWING?
 Use Permit Parcel Map Subdiv. Map GP Amend. Zone Change None

STAKE UP DATE	START DATE	COMPLETION DATE
TYPE OF ENCROACHMENT		
<input type="checkbox"/> Ag. Entrance – Security not required	\$625	*FEES ADOPTED BY THE AMADOR COUNTY BOARD OF SUPERVISORS ON 8.29.06 *EFFECTIVE ON 9.29.06 * FEE: \$625.00 + 75% of Contractor's Estimate for Security. The security will be refunded upon project completion. A site inspection fee of \$85 will be charged to determine if an existing encroachment meets County requirements. If it is approved "as is" all but the \$85 fee will be refunded.
<input type="checkbox"/> Driveway-Commercial	\$625	
<input type="checkbox"/> Driveway-Shared (list common addresses in project location)	\$625	
<input checked="" type="checkbox"/> Driveway-Standard Residential	\$625	
<input type="checkbox"/> Mailbox	\$ 25	
<input type="checkbox"/> Signage in Right of Way	\$625	
<input type="checkbox"/> Site inspection	\$ 85	
<input type="checkbox"/> Special Event in Right of Way***	\$625	
<input type="checkbox"/> Standard Road Connection	\$625	
<input type="checkbox"/> Temporary Access – Security Required	\$ 50	
<input type="checkbox"/> Traffic control	\$625	
<input type="checkbox"/> Trenching/Boring(for electric, water, sewer, phone)	\$625	
<input type="checkbox"/> Utility crossing under road	\$625	
<input type="checkbox"/> Other (please describe)	\$625	

***Applications for Special Events must be submitted at least thirty (30) days prior to event to allow for processing of insurance requirements.

DEPOSIT AMOUNT		\$ 2100.00
PERMIT FEE	RECEIPT # 2805431	\$ 625.00
TOTAL PAID		\$
RECEIVED BY: <u>RS</u>	DATE: 2/24/2020	BALANCE \$ 5725.00

OWNER OR AUTHORIZED AGENT SIGNATURE [Signature]
 TODAY'S DATE 2-24-2020 EXPIRATION DATE: _____

• All permits OTHER THAN THOSE issued to PUBLIC AGENCY or PUBLIC UTILITY having lawful authority to occupy the highways are revocable on five days' notice and the encroachment must be removed or relocated as may be specified by the road commissioner in the notice revoking the permit and within a reasonable time specified by the road commissioner unless the permit provides a specified time.

